

# Glens Falls Area

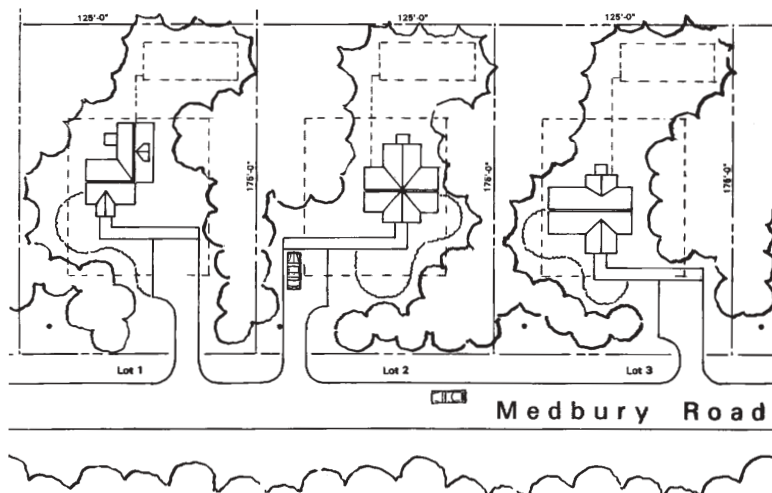

Serving Warren, Washington & Northern Saratoga Counties



## From the President's Desk...

Stephen McCorkell

I think by now you may have noticed that the Affiliate newsletter has a bold new look. This new look is symbolic of our efforts to increase the Affiliate's public image and our ongoing efforts to professionalize the services we offer in the community. The efforts by the board of directors are also mirrored by the work that each committee is doing to increase their level of operational effectiveness and organization.

For the past year the Affiliate has been more actively working to accomplish our mission by implementing a variety of partnership initiatives. I have been overwhelmed by the expression of support for our mission that has been demonstrated by a wide variety of organizations. With this in mind, we decided to explore the theme of **partnership** within the pages of our first "new" newsletter.

Partnership with families is of course the cornerstone of Habitat for Humanity's mission. The end result of that partnership is expressed in the form of a new home.

Unknown to many, is the number of subordinate partnerships that are required to build a new house. GFAHFH was built upon the strength of a vast network of individual volunteers who shared our vision. This type of partnership continues to form the backbone of our organization. However, it seems that we are only beginning to tap the resources that exist beyond our core group of volunteers. Combining the collective resources of our traditional individual volunteers with those of larger outside organizations is the key to creating an affiliate that benefits from a broad base of community support. Together we can muster the resources to meet the challenge of eliminating substandard housing in our service area.

The first test of this concept will be our partnership with Skidmore College. In May, Skidmore College and their student Habitat affiliate will be sponsoring the first build on one of the six newly acquired lots in the town of Greenfield. This "cluster" build is the largest project ever attempted by the Affiliate. Skidmore College has committed

SPRING  
2003

### INSIDE:

President's Desk.....	1
Family Partnership.....	2
New National Partnership Focuses on Family Support ..	2
Public Relations Committee Community Outreach .....	3
In Partnership with Church Relations .....	3
Partnerships Making the Dream of Homeowner- ship a Reality .....	3
Building with Partners .....	4
Upcoming Events .....	4

### Board of Directors

Stephen McCorkell • *President*  
Kern Swoboda • *Vice President*  
Louis DeSare • *Secretary*  
Judy Wilming • *Treasurer*  
Debbie Gordon • *Assistant Treasurer*  
Jim Farley  
Nancy Flint-Budde  
Betty Harris  
Chuck Jacox  
Brad Krause  
Jean McAdam  
Marie Murphy  
Ralph Nicolson  
Mildred Reid  
Richard Vallone  
Nicole Bissonette

### Committee Chairs

Family Selection • *Nancy Flint-Budde*  
Family Partnership • *Betty Harris*  
Site Selection • *Ken Cartledge*  
Construction • *Stephen McCorkell*  
Public Relations • *Marie Murphy*  
Church Relation • *Ralph Nicolson  
and Dick Harris*  
SHOP Grants • *Paul Arends*  
Newsletter Editor • *Shellene Warner*

**Family Partnership**

Betty Harris  
& Michele AuClaire

Our newest homeowners are Michele and Scott AuClaire. Recently Michele and I talked about their partnership with GFAHFH. The following comments were taken from that conversation:

“Achieving homeownership was a long haul for us. We waited patiently for our chance to build and we are now living in our own home. Sometimes I can’t believe it, but it’s for real!

I have decided to volunteer with the Partnership Committee because after being connected with the Affiliate for the past five years, I could not walk away knowing that other families need help.

As a committee member I want to help new families. I can speak to them about our experiences and work with them through the build process. In the end, I think that they will agree that homeownership is one of the best things that can happen to you.

Hopefully, working with other families will convince them that giving back after their build is complete is also a part of the process. They can continue their partnership with the Affiliate at other builds or by simply supporting one of the committees.

I think they will find, as I did, that the best part about building with Habitat is meeting wonderful and caring people.” ▲

**New National Partnership Focuses on Family Support**

Kathryn Wolf

A national resource organization for community-based family-serving programs, Family Support America promotes an approach to strengthening and empowering families and communities –called “family support” –that is preventive, responsive, flexible, family-focused, strengths-based and holistic. The approach, detailed in the principles of family support practice, is a perfect fit with HFHI’s work to build quality houses in strong communities in which people can live and grow.

As a result of the new partnership, Family Support America and HFHI will work together to infuse the principles of family support practice into HFHI’s strategies to strengthen and support Habitat homebuyers, their families and the communities in which they live. The partnership will:

- Connect Habitat affiliates across the U.S. with local family support programs
- Train Habitat staff in family support
- Provide national and regional training for staff at both organizations
- Bring Habitat homebuyers together to share ideas at the national level
- Pilot and showcase a model for a relationship-building process
- Enable Family Support America and HFHI to share promotional materials

Both Family Support America and HFHI encourage, support and assist organizations in direct relationships with families. Both recognize the critical need for agencies, organizations, families and programs to work in symbiotic relationships designed to strengthen families and communities and to build on families’ strengths and assets. ▲

**From the President's Desk... continued**

Stephen McCorkell

to organizing all aspects of the build. In addition to this effort, the Affiliate and Skidmore are working on a long-term plan to partner the academic side of the college with several of our committees. Needless to say, the opportunities presented by this partnership are endless.

To capitalize on these and other partnership opportunities requires significant resources. The board of directors is very pleased to announce that the Affiliate will again be one of the beneficiaries of proceeds raised by the 2003 Showcase of Homes event. This annual event is produced by the Saratoga Builders Association and partially staffed by affiliate volunteers. This partnership forms the cornerstone of our fundraising efforts in

Saratoga County. Our vision is to develop new partnerships in Warren and Washington County that will have similar results. To jumpstart that process we are working to add a number of new congregations to the ranks of our Covenant Church program. Our partnership with participant church congregations continues to serve as an invaluable source of prayers, volunteers and funds. Over the next year we will be working proactively to increase the Habitat presence in congregations throughout our service area.

As you can tell, things are busy and help is always needed. So please contact our volunteer coordinator if you would like to **Partner with Habitat!** ▲

## Public Relations Committee Community Outreach

Marie Murphy

The Public Relations Committee has been contacted by a number of organizations in the past six months, requesting information on Habitat for Humanity and specifically our affiliate's work. Our committee is very fortunate to have Dick Harris as a member, who along with our President Steve McCorkell, has ventured forth into the community to spread the word. In the past few months Dick and Steve have appeared at the Hartford Seniors' Center, The Lake Luzerne Career Wellness Fair at the Hadley-Luzerne Library, The Competitive Edge Free Youth Program in Glens Falls and the First Baptist Church in Glens Falls. Dick's presentations have been well received and we are very happy that he has chosen to partner with this committee.

We've also made it to the airwaves. Late last year, Steve and Dick were invited to be guests on the Lake Region Radio Coffee Hour in Poultney, Vermont. We are so grateful to the community for their interest in our program and for inviting us to share the information. In the near future, some of these groups will partner with us to help make another family's dream come true.

Our committee this year is rounded out by Kern Swoboda (our computer wizard), and Shellene Warner, who has a background in public relations. She brings valuable experience to this committee and we are glad she has joined us.

If you would like to schedule a speaker for your group, please contact Dick Harris at 793-7484. ▲

## In Partnership with Church Relations

Dick Harris

At first glance the theme of partnership and our Church Relations effort did not seem to be connected. But as I thought about it, I realized that they have a lot in common. Look at it this way; when I am speaking to a group (church, senior citizens, community, youth) I am establishing a partnership between Habitat for Humanity and that group. Habitat's mission includes all of us whether we are committee members, site volunteers, lunch providers, or homeowner families. The group being addressed hopefully includes future board members, committee members, or prospective homeowners.

Now, let's take it a step further. Every time you talk to anyone about Habitat's

mission you are forming a partnership. Your actions and words are going to be considered "gospel" by the listener, because "you are the one who knows." Your conversation can be with one or one hundred people. You are in effect, spreading the "gospel" of Habitat for Humanity and that makes us all members of the Church Relations Committee. So, I welcome all of you who did not know that you were on the committee. Keep spreading the word in this exciting time of growth for the Glens Falls Area Habitat for Humanity affiliate!!! ▲

## Partnerships Making the Dream of Homeownership a Reality

Nancy Flint-Budde

Our Family Selection Committee has been finalizing the approval process on our two families for the 2003 GFAHFH builds. The focus now shifts to applicants for homes to be built in 2004 and our desire to *get the word out!!!*

Traditionally applicants have been referred by Habitat friends and family, but we'd like to broaden the reach. Please partner with us to encourage applications from your church and hometown. The qualifications for potential homeowners include the need for improved housing due to current residence conditions, inability to qualify for a traditional bank mortgage, and that applicants either live or work in our affiliate's coverage area.

The application and complete guidelines can be found on our website at [www.glensfallshabitat.org](http://www.glensfallshabitat.org). Your partnership in this effort may make the dream of home ownership a reality for someone in your community. ▲

### Upcoming Events

On June 26th there is going to be a **golf tournament** sponsored by the LA Group to benefit GFAHFH.

Please call **793-7484** if you would like to register or volunteer for this event.

### Building with Partners

Stephen McCorkell

There is a saying in the world of development that goes something like “all the easy jobs have already been done”. Seemingly this is true, as we try to execute new builds on sites that are not always ideal and with building codes that are becoming more complex with each passing year. Executing the “hard” projects requires an organization that can form and manage a wide variety of partnerships. During any given build, these partnerships most often include local building code officials, planning boards, contractors, subcontractors, professional consultants, suppliers, trade unions, churches, and individual volunteers.

Over the past year the Construction Committee has been working on one of those “not so easy” projects. Our Mud

Pond Road house required variances, non-standard architectural plans, specialty framing, structural repairs, and new utility installations. However, each hurdle was overcome due to diversity of skills that were brought to the table by our project partners.

In the next year the Affiliate will be executing its first “blitz” build project. This type of project is perhaps the ultimate test of a partnership, requiring intense planning for the pre-positioning of materials and scheduling of volunteer labor. Other projects that are “on the boards” include builds within larger economic development projects. These grant-funded projects will involve the Affiliate with federal, state, and local government entities. ▲

Habitat for Humanity  
P.O. Box 4206  
Queensbury, NY 12804-0206

(518) 793-7484  
[www.GlensFallsHabitat.org](http://www.GlensFallsHabitat.org)  
(Return Service Requested)

Nonprofit Org.  
U.S. Postage  
PAID  
Glens Falls, NY  
Permit No. 161